

RESOLUTION NO. 21-100

**RESOLUTION EXPANDING RURAL SPECIAL
IMPROVEMENT MAINTENANCE DISTRICT #821M
(BLACK ROCK ESTATES)**

WHEREAS, pursuant to §7-12-2161(4), MCA, the Commissioners have the power of changing, by resolution, the boundaries of any maintenance district not more than once a year; and

WHEREAS the boundaries of RSID 821M have not been changed within the last year; and

WHEREAS, it has been determined that properties adjacent to the existing Rural Special Improvement District 821M boundaries are benefited properties accessing the district roads and dry hydrant due to the release of Phase 2 in Black Rock Estates; and

WHEREAS, the benefited property status requires the expansion of boundaries for RSID 821M for the maintenance, preservation and repair of the dry hydrant and roads located within the district boundaries; and

WHEREAS, the boundaries of the district will be expanded to include phase two of Black Rock Estates Yellowstone County, Montana, described in Exhibit B; and

WHEREAS, lots to be added to the district and boundaries of the expanded district are shown in Exhibit A (map).

NOW, THEREFORE, BE IT RESOLVED by the Board of County Commissioners of Yellowstone County, Montana, deeming the public interest or convenience require, will expand the following described Rural Special Improvement Maintenance District:

- 1. DESCRIPTION OF IMPROVEMENTS, DESCRIPTION OF MAINTENANCE, METHOD OF ASSESSMENT AND ESTIMATED COSTS.** Assessments collected on behalf of this district shall be used for the maintenance and preservation roads and dry hydrant located within the boundaries of this district. All of the costs of the district shall be assessed equally on a per lot method for existing and future lots. Assessments will be established annually by the Board of County Commissioners and are subject to adjustment due to cost fluctuations related to maintenance utilization levels and changes in material and labor costs of performing necessary maintenance.
- 2. DURATION.** The district shall be deemed to be perpetual in nature unless absorbed and replaced by another district or municipality.

Page 2
Resolution Expanding
RSID #821M

PASSED AND ADOPTED by the Board of County Commissioners of Yellowstone
County, Montana, this 23rd day of November, 2021.

BOARD OF COUNTY COMMISSIONERS
YELLOWSTONE COUNTY, MONTANA



Donald W. Jones, Chairman

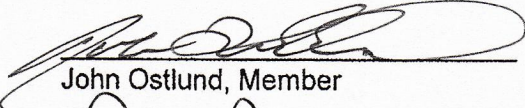

John Ostlund, Member

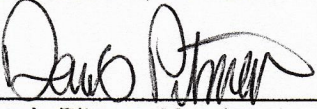

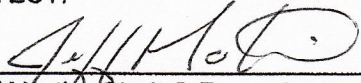

Denis Pitman, Member

(SEAL)
ATTEST:



Jeff Martin, Clerk & Recorder
Yellowstone County, Montana

**RSID 821M
EXHIBIT A**

 New Expansion Area
 RSID 821M

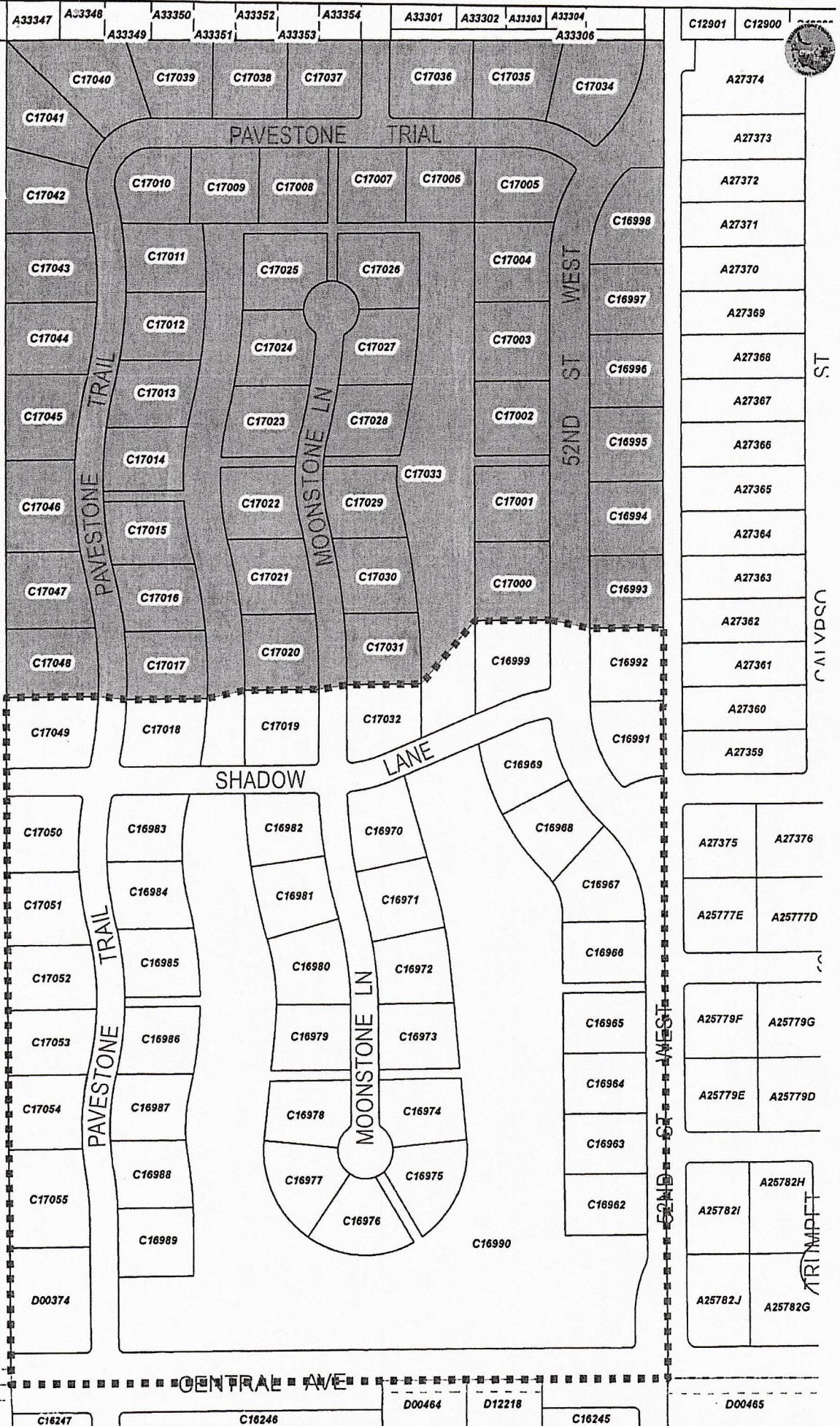

This document is intended for informational purposes only and is not guaranteed to be accurate nor current.

Exhibit B

Tax ID	Assessment	Owner Name	Full Address	Legal Description
Current RSID 821M				
1 C16962	\$ 200.00	HAIDLE, JERRY DEAN & NICOLE SHERMAN	104 52ND ST W	BLACK ROCK ESTATES SUBD (16), S04, T01 S, R25 E, BLOCK 1, Lot 1
2 C16963	\$ 200.00	BROWN BUILDERS LLC	110 52ND ST W	BLACK ROCK ESTATES SUBD (16), S04, T01 S, R25 E, BLOCK 1, Lot 2
3 C16964	\$ 200.00	WALSTON, JEREMY & MELANA	116 52ND ST W	BLACK ROCK ESTATES SUBD (16), S04, T01 S, R25 E, BLOCK 1, Lot 3
4 C16965	\$ 200.00	MAHN, TRAVIS & HILLARY	122 52ND ST W	BLACK ROCK ESTATES SUBD (16), S04, T01 S, R25 E, BLOCK 1, Lot 4
5 C16966	\$ 200.00	BERUBE, DEREK & KAYLA	200 52ND ST W	BLACK ROCK ESTATES SUBD (16), S04, T01 S, R25 E, BLOCK 1, Lot 5
6 C16967	\$ 200.00	BROWN BUILDERS LLC	208 52ND ST W	BLACK ROCK ESTATES SUBD (16), S04, T01 S, R25 E, BLOCK 1, Lot 6
7 C16968	\$ 200.00	JOHNSON, DOLORES M & DAVID P	214 52ND ST W	BLACK ROCK ESTATES SUBD (16), S04, T01 S, R25 E, BLOCK 1, Lot 7
8 C16969	\$ 200.00	SCHREINER, ANDREW & NICOLE	522D EVENING SHADOW LN	BLACK ROCK ESTATES SUBD (16), S04, T01 S, R25 E, BLOCK 1, Lot 8
9 C16970	\$ 200.00	ALTHOFF, JAMES A & KENA D	217 MOONSTONE LN	BLACK ROCK ESTATES SUBD (16), S04, T01 S, R25 E, BLOCK 1, Lot 9
10 C16971	\$ 200.00	NEARPASS, BRIAN D & SHELLY K	201 MOONSTONE LN	BLACK ROCK ESTATES SUBD (16), S04, T01 S, R25 E, BLOCK 1, Lot 10
11 C16972	\$ 200.00	NEUGEBAUER, DUANE E & DAWN MARIE	115 MOONSTONE LN	BLACK ROCK ESTATES SUBD (16), S04, T01 S, R25 E, BLOCK 1, Lot 11
12 C16973	\$ 200.00	CONVERSE, THOMAS & LESLIE	107 MOONSTONE LN	BLACK ROCK ESTATES SUBD (16), S04, T01 S, R25 E, BLOCK 1, Lot 12
13 C16974	\$ 200.00	HILL, MASON S & RUTH J	103 MOONSTONE LN	BLACK ROCK ESTATES SUBD (16), S04, T01 S, R25 E, BLOCK 1, Lot 13
14 C16975	\$ 200.00	AUSTIN, DAVID P & JESSICA	100 MOONSTONE LN	BLACK ROCK ESTATES SUBD (16), S04, T01 S, R25 E, BLOCK 1, Lot 14
15 C16976	\$ 200.00	NICASTRO, ANTHONY & JAIME	104 MOONSTONE LN	BLACK ROCK ESTATES SUBD (16), S04, T01 S, R25 E, BLOCK 1, Lot 15
16 C16977	\$ 200.00	MCCAULEY, ABE & TONYA	108 MOONSTONE LN	BLACK ROCK ESTATES SUBD (16), S04, T01 S, R25 E, BLOCK 1, Lot 16
17 C16978	\$ 200.00	HIGHTOWER, RHETT D & ALEXIS I	116 MOONSTONE LN	BLACK ROCK ESTATES SUBD (16), S04, T01 S, R25 E, BLOCK 1, Lot 17
18 C16979	\$ 200.00	SALEEBY, EDWARD R & DEBORAH L	204 MOONSTONE LN	BLACK ROCK ESTATES SUBD (16), S04, T01 S, R25 E, BLOCK 1, Lot 18
19 C16980	\$ 200.00	DAVIS, NATHAN J & KELLY S	212 MOONSTONE LN	BLACK ROCK ESTATES SUBD (16), S04, T01 S, R25 E, BLOCK 1, Lot 19
20 C16981	\$ 200.00	DAY, ROBERT E & KERRY K	220 MOONSTONE LN	BLACK ROCK ESTATES SUBD (16), S04, T01 S, R25 E, BLOCK 1, Lot 20
21 C16982	\$ 200.00	WARD, DAVID C & VALERIE J	211 PAVESTONE TRL	BLACK ROCK ESTATES SUBD (16), S04, T01 S, R25 E, BLOCK 1, Lot 21
22 C16983	\$ 200.00	EDWARD AND CHARLENE SAUNDERS LIVING TRUST	203 PAVESTONE TRL	BLACK ROCK ESTATES SUBD (16), S04, T01 S, R25 E, BLOCK 1, Lot 22
23 C16984	\$ 200.00	DELPRIORE, SCOTT	121 PAVESTONE TRL	BLACK ROCK ESTATES SUBD (16), S04, T01 S, R25 E, BLOCK 1, Lot 23
24 C16985	\$ 200.00	DURELL, PAULA M & GARY M	115 PAVESTONE TRL	BLACK ROCK ESTATES SUBD (16), S04, T01 S, R25 E, BLOCK 1, Lot 24
25 C16986	\$ 200.00	COX, SHAUN D & ANDREA M	109 PAVESTONE TRL	BLACK ROCK ESTATES SUBD (16), S04, T01 S, R25 E, BLOCK 1, Lot 25
26 C16987	\$ 200.00	KLAWIKOWSKI, KEITH E & TANVA	103 PAVESTONE TRL	BLACK ROCK ESTATES SUBD (16), S04, T01 S, R25 E, BLOCK 1, Lot 26
27 C16988	\$ 200.00	BROWN DEVELOPMENT LLC	217 52ND ST W	BLACK ROCK ESTATES SUBD (16), S04, T01 S, R25 E, BLOCK 1, Lot 27
28 C16989	\$ 200.00	BROWN DEVELOPMENT LLC	307 52ND ST W	BLACK ROCK ESTATES SUBD (16), S04, T01 S, R25 E, BLOCK 2, Lot 1
29 C16991	\$ 200.00	WEINHEIMER, MICHAEL P	5219 EVENING SHADOW LN	BLACK ROCK ESTATES SUBD (16), S04, T01 S, R25 E, BLOCK 2, Lot 2
30 C16992	\$ 200.00	BROWN DEVELOPMENT LLC	5319 EVENING SHADOW LN	BLACK ROCK ESTATES SUBD (16), S04, T01 S, R25 E, BLOCK 3, Lot 1
31 C16999	\$ 200.00	BROWN DEVELOPMENT LLC	5311 EVENING SHADOW LN	BLACK ROCK ESTATES SUBD (16), S04, T01 S, R25 E, BLOCK 3, Lot 20
32 C17018	\$ 200.00	OLIVER, MATTHEW JAMES & KYNZIE LEE	5229 EVENING SHADOW LN	BLACK ROCK ESTATES SUBD (16), S04, T01 S, R25 E, BLOCK 3, Lot 21
33 C17019	\$ 200.00	GRAY, DUFF & ANGELA	302 PAVESTONE TRL	BLACK ROCK ESTATES SUBD (16), S04, T01 S, R25 E, BLOCK 3, Lot 34
34 C17032	\$ 200.00	SORENSEN, JAN A & LANAK	218 PAVESTONE TRL	BLACK ROCK ESTATES SUBD (16), S04, T01 S, R25 E, BLOCK 5, Lot 13
35 C17049	\$ 200.00	STRIEGEL, JAMES J & LEA M	210 PAVESTONE TRL	BLACK ROCK ESTATES SUBD (16), S04, T01 S, R25 E, BLOCK 6, Lot 1
36 C17050	\$ 200.00	BROWN BUILDERS LLC	202 PAVESTONE TRL	BLACK ROCK ESTATES SUBD (16), S04, T01 S, R25 E, BLOCK 6, Lot 2
37 C17051	\$ 200.00	BROWN BUILDERS LLC	120 PAVESTONE TRL	BLACK ROCK ESTATES SUBD (16), S04, T01 S, R25 E, BLOCK 6, Lot 4
38 C17052	\$ 200.00	BROWN BUILDERS LLC	114 PAVESTONE TRL	BLACK ROCK ESTATES SUBD (16), S04, T01 S, R25 E, BLOCK 6, Lot 5
39 C17053	\$ 200.00	MORT, COLE E & KAYLI E	108 PAVESTONE TRL	BLACK ROCK ESTATES SUBD (16), S04, T01 S, R25 E, BLOCK 6, Lot 6
40 C17054	\$ 200.00	BROWN DEVELOPMENT LLC	102 PAVESTONE TRL	BLACK ROCK ESTATES SUBD (16), S04, T01 S, R25 E, BLOCK 6, Lot 7
41 C17055	\$ 200.00			
42 D00374	\$ 200.00			
	\$ 8,400.00			

New Expansion of RSID 821M

1	CL6993	\$	200.00	BROWN DEVELOPMENT LLC	401 52ND ST W	BLACK ROCK ESTATES SUBD (16), S04, T01 S, R25 E, BLOCK 2, Lot 3
2	CL6994	\$	200.00	BROWN DEVELOPMENT LLC	409 52ND ST W	BLACK ROCK ESTATES SUBD (16), S04, T01 S, R25 E, BLOCK 2, Lot 4
3	CL6995	\$	200.00	BROWN DEVELOPMENT LLC	501 52ND ST W	BLACK ROCK ESTATES SUBD (16), S04, T01 S, R25 E, BLOCK 2, Lot 5
4	CL6996	\$	200.00	BROWN DEVELOPMENT LLC	509 52ND ST W	BLACK ROCK ESTATES SUBD (16), S04, T01 S, R25 E, BLOCK 2, Lot 6
5	CL6997	\$	200.00	BROWN DEVELOPMENT LLC	517 52ND ST W	BLACK ROCK ESTATES SUBD (16), S04, T01 S, R25 E, BLOCK 2, Lot 7
6	CL6998	\$	200.00	BROWN DEVELOPMENT LLC	525 52ND ST W	BLACK ROCK ESTATES SUBD (16), S04, T01 S, R25 E, BLOCK 2, Lot 8
7	CL7000	\$	200.00	BROWN DEVELOPMENT LLC	402 52ND ST W	BLACK ROCK ESTATES SUBD (16), S04, T01 S, R25 E, BLOCK 3, Lot 1
8	CL7001	\$	200.00	BROWN DEVELOPMENT LLC	410 52ND ST W	BLACK ROCK ESTATES SUBD (16), S04, T01 S, R25 E, BLOCK 3, Lot 2
9	CL7002	\$	200.00	BROWN DEVELOPMENT LLC	502 52ND ST W	BLACK ROCK ESTATES SUBD (16), S04, T01 S, R25 E, BLOCK 3, Lot 3
10	CL7003	\$	200.00	BROWN DEVELOPMENT LLC	510 52ND ST W	BLACK ROCK ESTATES SUBD (16), S04, T01 S, R25 E, BLOCK 3, Lot 4
11	CL7004	\$	200.00	BROWN DEVELOPMENT LLC	518 52ND ST W	BLACK ROCK ESTATES SUBD (16), S04, T01 S, R25 E, BLOCK 3, Lot 5
12	CL7005	\$	200.00	BROWN DEVELOPMENT LLC	524 52ND ST W	BLACK ROCK ESTATES SUBD (16), S04, T01 S, R25 E, BLOCK 3, Lot 6
13	CL7006	\$	200.00	BROWN DEVELOPMENT LLC	707 PAVESTONE TRL	BLACK ROCK ESTATES SUBD (16), S04, T01 S, R25 E, BLOCK 3, Lot 7
14	CL7007	\$	200.00	BROWN DEVELOPMENT LLC	701 PAVESTONE TRL	BLACK ROCK ESTATES SUBD (16), S04, T01 S, R25 E, BLOCK 3, Lot 8
15	CL7008	\$	200.00	BROWN DEVELOPMENT LLC	619 PAVESTONE TRL	BLACK ROCK ESTATES SUBD (16), S04, T01 S, R25 E, BLOCK 3, Lot 9
16	CL7009	\$	200.00	BROWN DEVELOPMENT LLC	613 PAVESTONE TRL	BLACK ROCK ESTATES SUBD (16), S04, T01 S, R25 E, BLOCK 3, Lot 10
17	CL7010	\$	200.00	BROWN DEVELOPMENT LLC	525 PAVESTONE TRL	BLACK ROCK ESTATES SUBD (16), S04, T01 S, R25 E, BLOCK 3, Lot 11
18	CL7011	\$	200.00	BROWN DEVELOPMENT LLC	519 PAVESTONE TRL	BLACK ROCK ESTATES SUBD (16), S04, T01 S, R25 E, BLOCK 3, Lot 12
19	CL7012	\$	200.00	BROWN DEVELOPMENT LLC	513 PAVESTONE TRL	BLACK ROCK ESTATES SUBD (16), S04, T01 S, R25 E, BLOCK 3, Lot 13
20	CL7013	\$	200.00	BROWN DEVELOPMENT LLC	507 PAVESTONE TRL	BLACK ROCK ESTATES SUBD (16), S04, T01 S, R25 E, BLOCK 3, Lot 14
21	CL7014	\$	200.00	BROWN DEVELOPMENT LLC	501 PAVESTONE TRL	BLACK ROCK ESTATES SUBD (16), S04, T01 S, R25 E, BLOCK 3, Lot 15
22	CL7015	\$	200.00	BROWN DEVELOPMENT LLC	409 PAVESTONE TRL	BLACK ROCK ESTATES SUBD (16), S04, T01 S, R25 E, BLOCK 3, Lot 16
23	CL7016	\$	200.00	BROWN DEVELOPMENT LLC	401 PAVESTONE TRL	BLACK ROCK ESTATES SUBD (16), S04, T01 S, R25 E, BLOCK 3, Lot 17
24	CL7017	\$	200.00	BROWN DEVELOPMENT LLC	309 PAVESTONE TRL	BLACK ROCK ESTATES SUBD (16), S04, T01 S, R25 E, BLOCK 3, Lot 18
25	CL7020	\$	200.00	BROWN DEVELOPMENT LLC	310 MOONSTONE LN	BLACK ROCK ESTATES SUBD (16), S04, T01 S, R25 E, BLOCK 3, Lot 19
26	CL7021	\$	200.00	BROWN DEVELOPMENT LLC	404 MOONSTONE LN	BLACK ROCK ESTATES SUBD (16), S04, T01 S, R25 E, BLOCK 3, Lot 20
27	CL7022	\$	200.00	BROWN DEVELOPMENT LLC	412 MOONSTONE LN	BLACK ROCK ESTATES SUBD (16), S04, T01 S, R25 E, BLOCK 3, Lot 21
28	CL7023	\$	200.00	HIGHTOWER, RHETT & ALEXIS	502 MOONSTONE LN	BLACK ROCK ESTATES SUBD (16), S04, T01 S, R25 E, BLOCK 3, Lot 22
29	CL7024	\$	200.00	BROWN DEVELOPMENT LLC	510 MOONSTONE LN	BLACK ROCK ESTATES SUBD (16), S04, T01 S, R25 E, BLOCK 3, Lot 23
30	CL7025	\$	200.00	BROWN DEVELOPMENT LLC	518 MOONSTONE LN	BLACK ROCK ESTATES SUBD (16), S04, T01 S, R25 E, BLOCK 3, Lot 24
31	CL7026	\$	200.00	BROWN DEVELOPMENT LLC	519 MOONSTONE LN	BLACK ROCK ESTATES SUBD (16), S04, T01 S, R25 E, BLOCK 3, Lot 25
32	CL7027	\$	200.00	BROWN DEVELOPMENT LLC	511 MOONSTONE LN	BLACK ROCK ESTATES SUBD (16), S04, T01 S, R25 E, BLOCK 3, Lot 26
33	CL7028	\$	200.00	BROWN DEVELOPMENT LLC	503 MOONSTONE LN	BLACK ROCK ESTATES SUBD (16), S04, T01 S, R25 E, BLOCK 3, Lot 27
34	CL7029	\$	200.00	BROWN DEVELOPMENT LLC	411 MOONSTONE LN	BLACK ROCK ESTATES SUBD (16), S04, T01 S, R25 E, BLOCK 3, Lot 28
35	CL7030	\$	200.00	BROWN DEVELOPMENT LLC	403 MOONSTONE LN	BLACK ROCK ESTATES SUBD (16), S04, T01 S, R25 E, BLOCK 3, Lot 29
36	CL7031	\$	200.00	BROWN DEVELOPMENT LLC	409 MOONSTONE LN	BLACK ROCK ESTATES SUBD (16), S04, T01 S, R25 E, BLOCK 3, Lot 30
37	CL7033	\$	200.00	BROWN DEVELOPMENT LLC	403 MOONSTONE LN	BLACK ROCK ESTATES SUBD (16), S04, T01 S, R25 E, BLOCK 3, Lot 31
38	CL7034	\$	200.00	BROWN DEVELOPMENT LLC	718 PAVESTONE TRL	BLACK ROCK ESTATES SUBD (16), S04, T01 S, R25 E, BLOCK 3, Lot 32
39	CL7035	\$	200.00	BROWN DEVELOPMENT LLC	712 PAVESTONE TRL	BLACK ROCK ESTATES SUBD (16), S04, T01 S, R25 E, BLOCK 3, Lot 33
40	CL7036	\$	200.00	BROWN DEVELOPMENT LLC	706 PAVESTONE TRL	BLACK ROCK ESTATES SUBD (16), S04, T01 S, R25 E, BLOCK 4, Lot 1
41	CL7037	\$	200.00	BROWN DEVELOPMENT LLC	620 PAVESTONE TRL	BLACK ROCK ESTATES SUBD (16), S04, T01 S, R25 E, BLOCK 4, Lot 2
42	CL7038	\$	200.00	BROWN DEVELOPMENT LLC	616 PAVESTONE TRL	BLACK ROCK ESTATES SUBD (16), S04, T01 S, R25 E, BLOCK 4, Lot 3
43	CL7039	\$	200.00	BROWN DEVELOPMENT LLC	610 PAVESTONE TRL	BLACK ROCK ESTATES SUBD (16), S04, T01 S, R25 E, BLOCK 4, Lot 4
44	CL7040	\$	200.00	BROWN DEVELOPMENT LLC	604 PAVESTONE TRL	BLACK ROCK ESTATES SUBD (16), S04, T01 S, R25 E, BLOCK 4, Lot 5
45	CL7041	\$	200.00	BROWN DEVELOPMENT LLC	530 PAVESTONE TRL	BLACK ROCK ESTATES SUBD (16), S04, T01 S, R25 E, BLOCK 4, Lot 6
46	CL7042	\$	200.00	BROWN DEVELOPMENT LLC	524 PAVESTONE TRL	BLACK ROCK ESTATES SUBD (16), S04, T01 S, R25 E, BLOCK 5, Lot 1
47	CL7043	\$	200.00	BROWN DEVELOPMENT LLC	518 PAVESTONE TRL	BLACK ROCK ESTATES SUBD (16), S04, T01 S, R25 E, BLOCK 5, Lot 2

48 C17044	\$	200.00	BROWN DEVELOPMENT LLC
49 C17045	\$	200.00	BROWN DEVELOPMENT LLC
50 C17046	\$	200.00	BROWN DEVELOPMENT LLC
51 C17047	\$	200.00	BROWN DEVELOPMENT LLC
52 C17048	\$	200.00	BROWN DEVELOPMENT LLC
		<u>\$ 10,400.00</u>	

512 PAVESTONE TRL
 504 PAVESTONE TRL
 410 PAVESTONE TRL
 402 PAVESTONE TRL
 310 PAVESTONE TRL

BLACK ROCK ESTATES SUBD (16), S04, T01 S, R25 E, BLOCK 5, Lot 8
 BLACK ROCK ESTATES SUBD (16), S04, T01 S, R25 E, BLOCK 5, Lot 9
 BLACK ROCK ESTATES SUBD (16), S04, T01 S, R25 E, BLOCK 5, Lot 10
 BLACK ROCK ESTATES SUBD (16), S04, T01 S, R25 E, BLOCK 5, Lot 11
 BLACK ROCK ESTATES SUBD (16), S04, T01 S, R25 E, BLOCK 5, Lot 12

\$ 18,800.00 New Total Assessment